

SUPPLEMENTAL PLAT OF ROSTINE'S SUB-DIVISION

BLOCK 2 FISHER'S ADDITION

TO

McPHERSON, KANSAS.

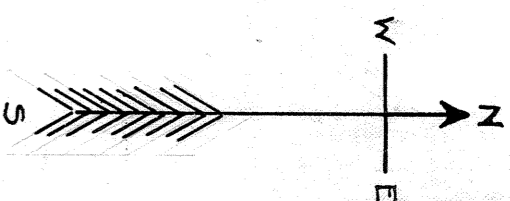

KANSAS

AVE.

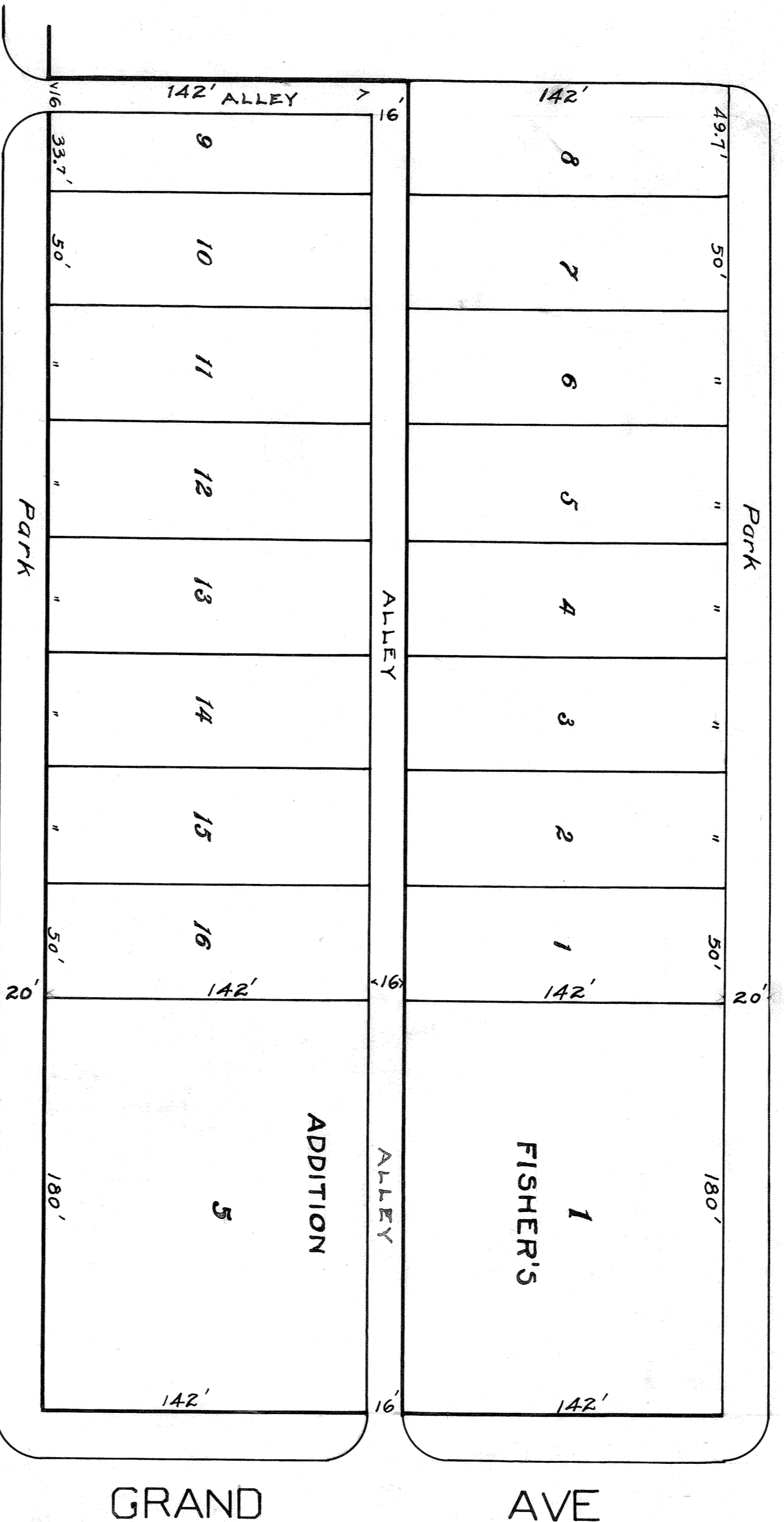

ELIZABETH

ST.

know all men by these presents that we Alfred Rostine and A. F. Carlson are the owners of lots 1, 9 and 16 of Rostine's Subdivision of Lots 2, 3 and 4 of Block 2, Fisher's Addition to McPherson, Kansas and of lots 1 and 5 of Block 2 of Fisher's addition to McPherson, Kansas, and that the disposition of said grounds is in accordance with our design and instructions. That the alleys as shown on the above plat are dedicated to the use of the public. Witness our hands this 30th day of September, A. D. 1907.

Alfred Rostine

A. F. Carlson

State of Kansas, McPherson Co. ss:
Be it remembered on this 30th day of September, A. D. 1907 before me, a Notary Public in and for the county and state aforesaid, personally appeared Alfred Rostine and A. F. Carlson, who are personally known to me to be the same persons who executed the foregoing instrument in writing, and each per-
sone duly acknowledged the execution of the same. In testimony whereof I have hereunto affixed my notarial seal, and set my hand the day and year last above written.

A. F. Carlson
Notary Public

My commission expires *Dec 29 1910*
Wm. A. H. S. O'S

This instrument was filed for record on the 1st day of Oct. A. D. 1907. 10:30 o'clock, and duly recorded in book 5 of page 11.

Geo. H. Steelbild
Register of Deeds